

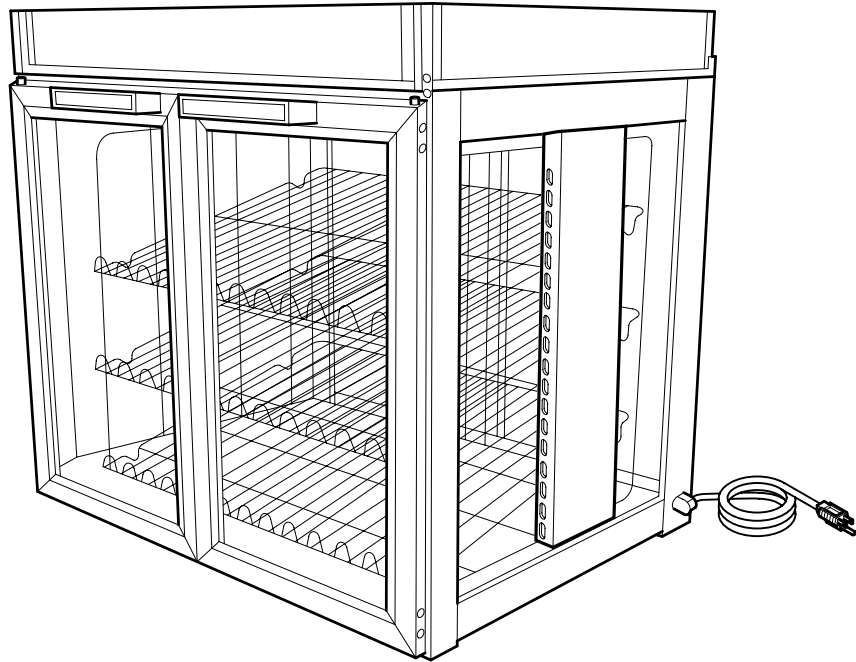

# REPLACEMENT PARTS LIST UPDATE



## AFST SERIES UNITS WITH SLIDING DOORS Model No. AFST-2X

I&W #07.05.085.00

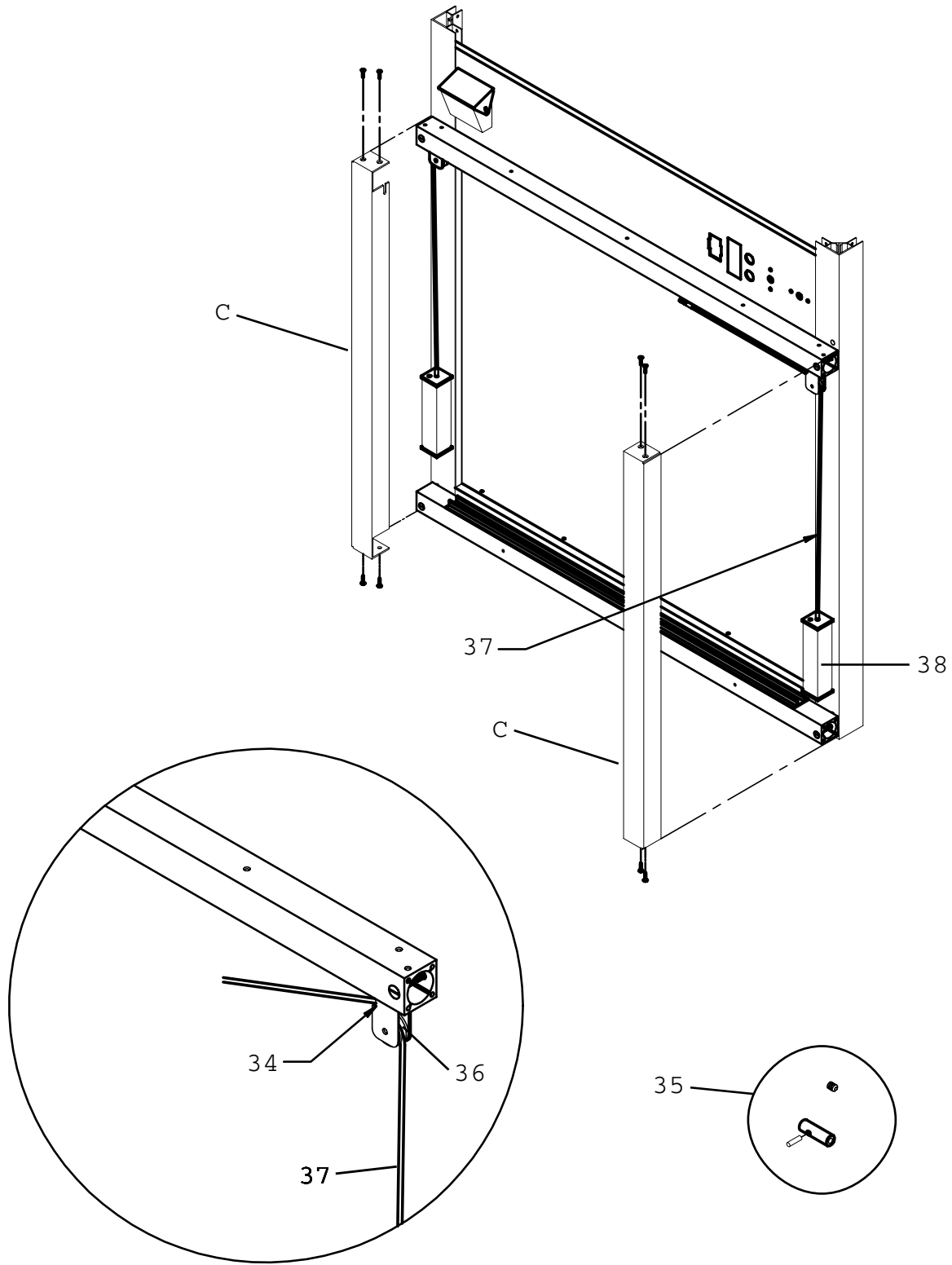

**NOTE:** Instructions on how to replace door cable listed on back page.

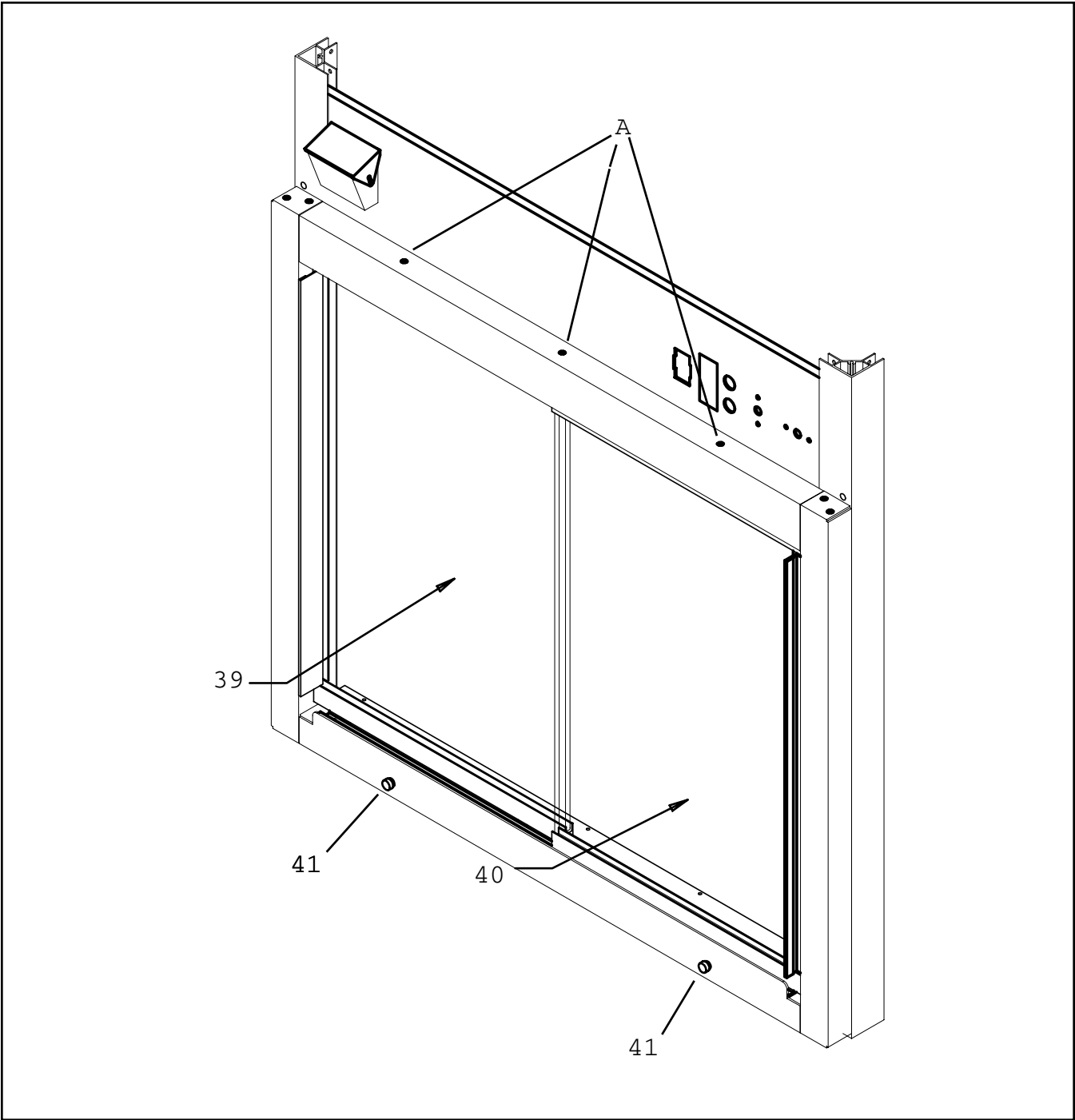

| ITEM | DESCRIPTION              | PART NO.       | QTY. |
|------|--------------------------|----------------|------|
| 34   | Bracket Assembly-Pulley  | 04.17.464.00   | 2    |
| 35   | Cable Connector Assembly | R04.17.472.00  | 2    |
| 36   | Idler Pulley             | 04.17.477.00   | 2    |
| 37   | Door Cable w/Fitting     | 04.17.480.00   | 2    |
| 38   | Counter Balance Assembly | R04.17.473.00  | 2    |
| 39   | Inner Door Assembly      | R00.01.0041.00 | 1    |
| 40   | Outer Door Assembly      | R00.01.0042.00 | 1    |
| 41   | Thumb Screws             | 05.04.445.00   | 2    |

**NOTE:** Instructions on how to replace door cable listed on back page.

## DOOR CABLE REPLACEMENT INSTRUCTIONS

1. Unplug unit from power source and allow to cool.
2. Remove black painted top cover.
3. Remove three screws that secure top black angle cover (see "A" page 3) and remove cover.
4. Remove two thumb screws that secure bottom black angle cover (Item #41) and remove cover.
5. Carefully and slowly remove doors by lifting each door up and then out.  
Disconnect cable from door assembly.
6. Remove two screws that secure upper door track and remove track.
7. Remove corner posts (see "C" page 2).
8. Disconnect cable from weight.
9. Disconnect cable connector from cable by rotating fitting counter clockwise.

**CAUTION:** Do not remove set screw.

10. Remove cable from unit.

Reinstall new cable in reverse order. Make sure cable is in "notch" when replacing corner posts.

---

---

### HATCO CORPORATION

P.O. Box 340500, Milwaukee, WI 53234-0500 U.S.A.

(800) 558-0607 (414) 671-6350

Parts & Service Fax (800) 690-2966 Int'l. Fax (414) 671-3976

[www.hatcocorp.com](http://www.hatcocorp.com)